

JOSTA DoubleParker-Systems



VerticalDoubleParker
DoubleParker Standard
DoubleParker with gas cylinder technology

VertikalDoubleParker (VDP)

Our VerticalDouble Parker offers efficient use of space on two levels. Even with a large number of bicycles, the automatic lift system allows safe and easy access to the bicycle. You can plan the size individually.

You can plan the size individually. The system only needs a room height of 2,40m.

The VDP ist the most comfortable and easiest to use double-park-system. For more safety and stability the system includes a leaning-safety-bracket.



Features VerticalDoubleParker (VDP)

- Optimizes parking opportunities for bicycles
- Allows efficient use of parking space
- Secure and ergonomic: The innovative lifting-system
- Usable for room heights from 2550mm or higher
- With safety brackets and rope locks

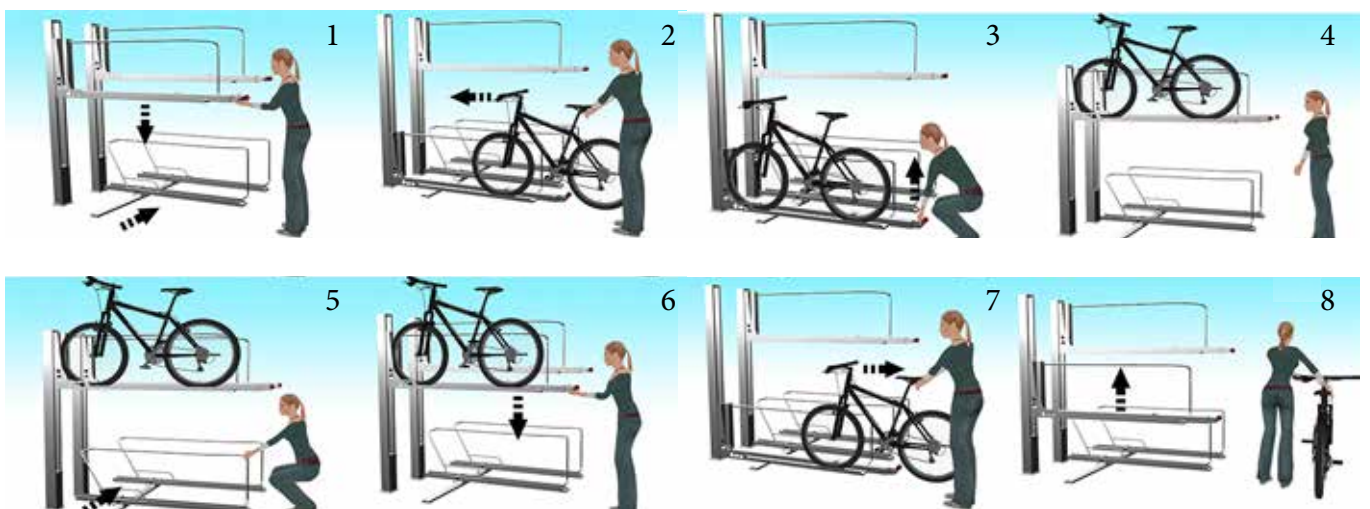

Technical information VertikalDoubleParker (VDP)

- No electronics or gas cylinders, so almost no maintenance
- Stable standing construction
- Ceiling heights from 2550mm or higher
- Width from 1500mm or higher

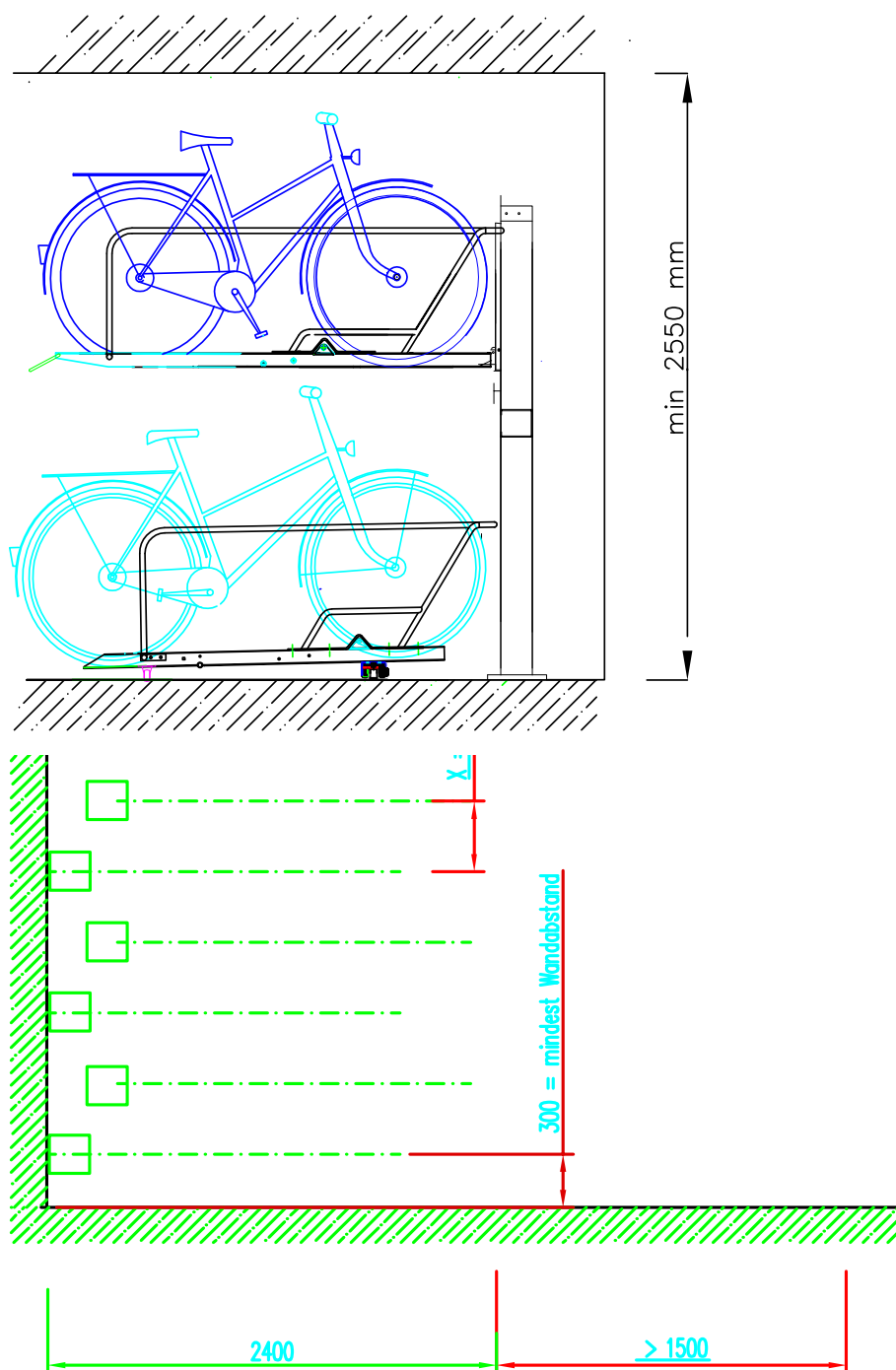

DoubleParker Standard

The classic DoubleParker Standard convinces not only by its high functionality, but also by its wide range of application and equipment options.

Bikes can be reached easily without disturbing noises. The innovative locking device keeps the bikes from rolling back.

Get what you need: Die size of DoubleParker can be planned individually.



Features DoppelParker Standard

- Extendable upper rail with high-low-standing
- Fold out the upper rail easily, without disturbing noises from PVC rolls
- Self-triggering locking device in the upper rail, which keeps the bike from rolling back
- Bikes will be fixed with rollback protections on both levels
- Bikes are held with self-triggering, patented safety brackets
- Modular system
- Upper and lower rail with movable safety brackets to prevent theft, what also makes the parking easier
- For an even more efficient way to save space you can integrate the DoubleParker into our bike-ceilings

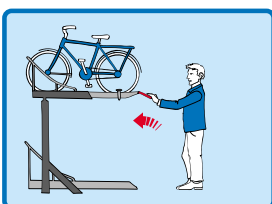
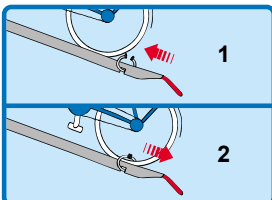
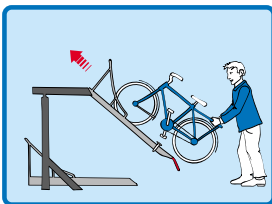
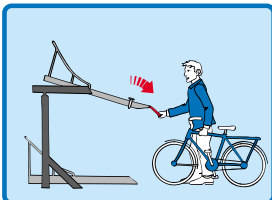

Safety bracket



Optionally with standing brackets



Available in all RAL colours

Technical information DoppelParker Standard

- Unsupported steel construction up to 4m
- High flexibility and many expansion opportunities thanks to our modular system
- Safe standing thanks to steel pillars on concrete, cobblestone and asphalt

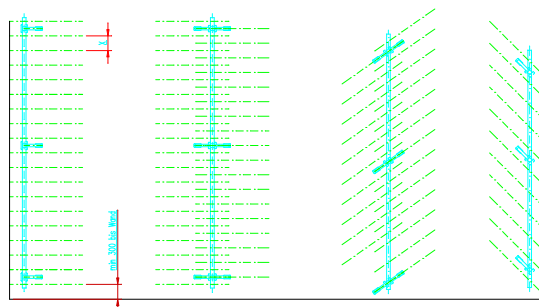
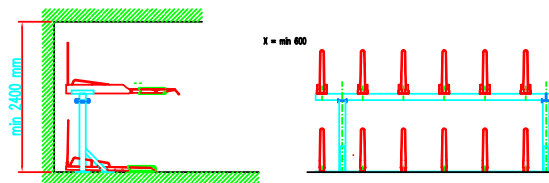
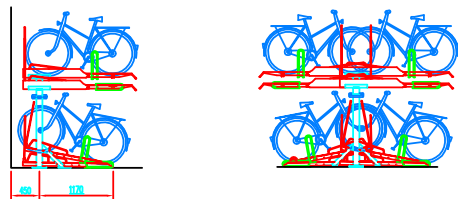
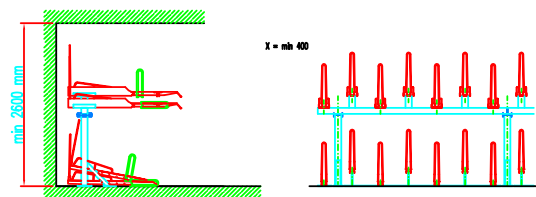
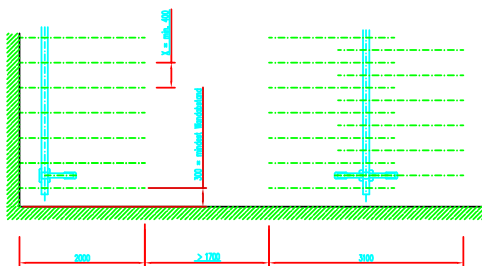

X = min. 400



DoubleParker with gas springs (DPG)

- Lifting-support with gas springs when lifting the bike up
- Prevents a fast and uncontrolled coming down from the upper rail
- Proved safety thanks to the EC-technology

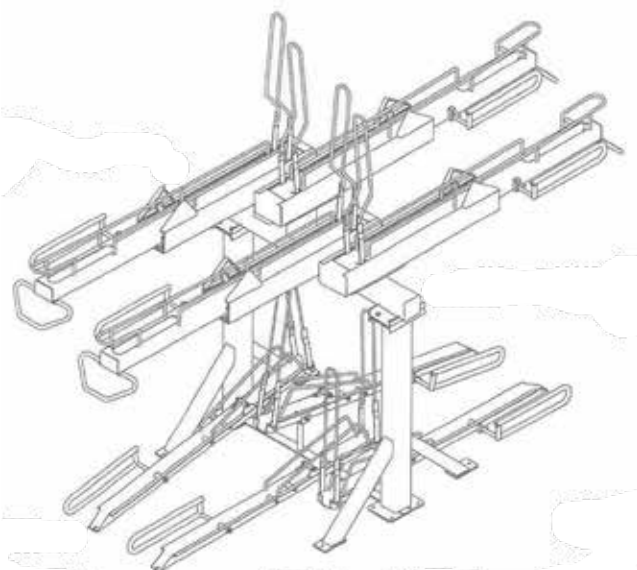

Features DPG

- Easy and comfortable usage
- Circumferentially folded sheet steel profile with concealed roller guides made of KS and stainless steel
- Patent protected vertical bar with automatic return
- Vandalism-inhibitory thanks to concealed stainless steel construction
- Integrated, vandal-proof and anti-theft special console with gas spring
- Bicycles can be brought into the horizontal position with almost no effort.
- Automatic lowering for effortless usage
- Modular system
- Available in all RAL colours
- The smooth guide rails for all tire widths prevent the accumulation of ice, water and debris.
- Semi-automatic bow with spring force, which adapts to the wheel sizes and thus prevents damage.



Technical information DPG

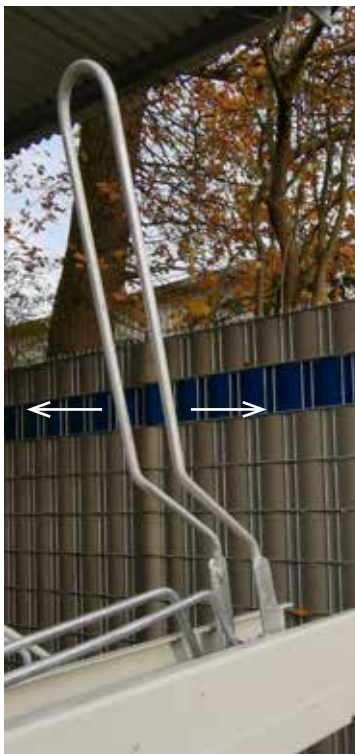
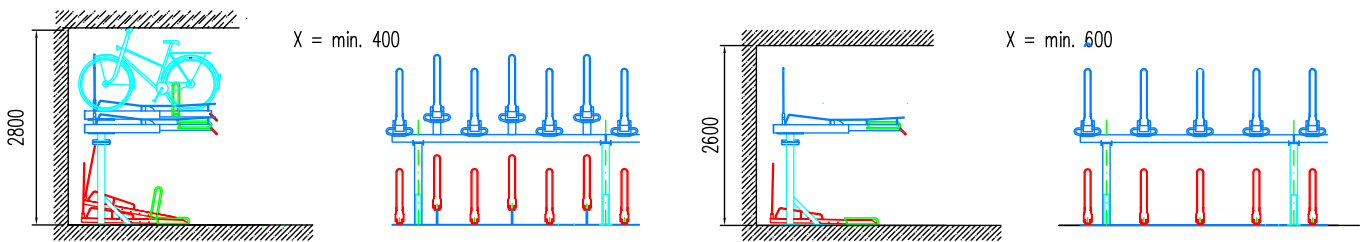

Automatic return mechanism



Safety bracket



Smooth guide rail

Text for tenders

Item	Qty.	Description of services
10		<p>"JOSTA Doubleparker®" bicycle parking units, Position: straight / left / right Axle base of the parking spaces:mm, Proof of delivery: JOSTA®</p> <p>All parts hot galvanised, for level-ground installation, self-supporting steel structure made of horizontal and vertical MSH tubes in statically required dimensions. Extendable top guide rails in top and bottom positions.</p> <p>Easy mechanical folding out and down of the top guide rail through to angled positioning without unpleasant noise thanks to the use of PVC guide rollers. When folded out, the top guides must allow parking of the bottom bicycles with rear baskets. Self-actuating locking mechanism in the top guide rail. It automatically secures the bicycle against rolling backwards on its own both in the angled position, in the parked position and when being moved. Widened ramp of the top guide rails. Handle covered by red silicone sheathing. Top and bottom guide rails with moving safety hoop, which allows trouble-free parking and removal of the bicycle in the lowered parked position. Includes moving, spring-supported retaining hoop for the front wheel. Secured to floor with stainless steel screws. Full delivery of bicycle parking unit and installed ready for use.</p>
20	... ct.	<p>Bicycle parking unit, bi-level forpositions, single-sided, axle base of the parking spaces:mm, structure length:m, otherwise as above</p>
30	... ct.	<p>Bicycle parking unit, bi-level forpositions, double-sided, axle base of the parking spaces:mm, structure length:m, otherwise as above</p>
40	... ct.	<p>Surcharge for equipping with integrated gas spring technology for the top position.</p> <ul style="list-style-type: none"> - Sheet-steel profile with turned-up edge around the circumference and concealed rolling guide made of KS and stainless steel - Smooth guide level for all tyre widths - Patented vertical hoop with automatic return mechanism - Subsurface-lying stainless-steel screw connections - Integrated vandalism- and theft-resistant special panel with gas spring - Maintenance-free construction

Projects

- Made in Germany
- Development and production of the first DoubleParker system more than 20 years ago
- European and worldwide models and patents
- Worldwide experience with DoubleParker systems in Europe, USA, Cyprus, Russia, Australia and Asia



Groningen, NL



Hongkong



London, UK



V.A.E



Seattle, USA



Bern, CH



Sydney, AU



Montreal, CA

Contact

JOSTA Technik GmbH
Buldernweg 50
48163 Münster
Deutschland

Tel: + 49 (0) 251 97 43 37 40
E-Mail: josta@josta.de
Web: www.josta.de